



How to convert systems Natural Gas to Liquid Propane

Burner Conversion



Removal of Natural Gas elbow
and orifice

Installation of LP air mixer
w/brass fitting

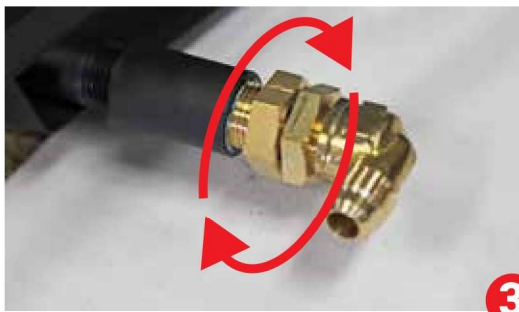
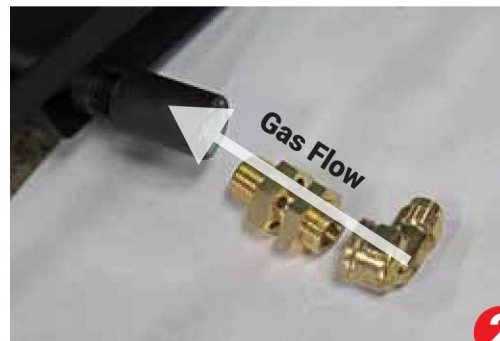

LP Conversion Kit Chart

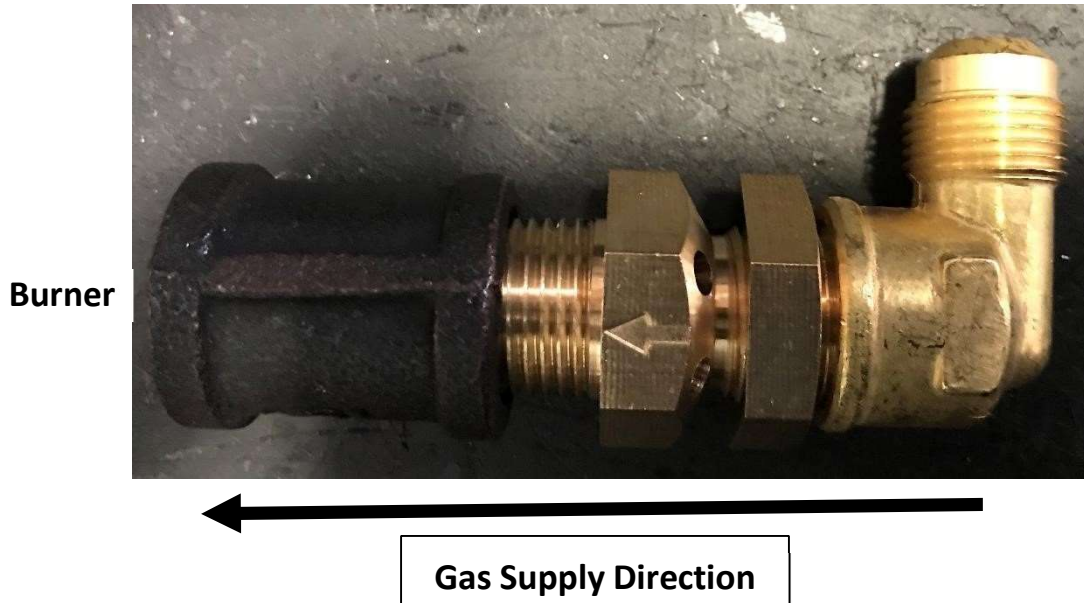

Drill Out orifice in brass air mixer according to the chart below.

***If fireplace is located above 4500 ft. elevation, a smaller orifice will be needed. Please call GCGL to determine the appropriate orifice size. ***

<u>STYLE</u>	<u>SIZE</u>	<u>BTU RATING</u>		<u>ORFICE #</u>
		<u>LP</u>	<u>LP</u>	<u>LP</u>
2 BURNER	18"	49K		45
	21"	58K		43
	24"	64K		41
	30"	79K		36
	36"	83K		7/64
	42"	87K		34
	48"	145K		27
	60"	165K		23
2 BURNER SEE-THROUGH	18"	93K		32
	24"	100K		31
	30"	115K		30
	36"	125K		28
	42"	130K		28
	48"	145K		27
	60"	165K		23

3 BURNER	18"	41K	48
	21"	58K	43
	24"	64K	41
	30"	91K	33
	36"	106K	31
	42"	121K	30
3 BURNER SEE-THROUGH	18"	93K	33
	24"	100K	31
	30"	115K	30
	36"	125K	28
	42"	130K	28
JUMBO SLIMLINE	24"	95K	32
	30"	110K	1/8
	36"	145K	27
	42"	160K	25
	48"	190K	20
	60"	225K	16
	72"	230K	15
JUMBO	36"	145K	27
	42"	160K	25
	48"	190K	20
	60"	225K	16
	72"	230K	15
	84"	240K	13
	96"	275K	9
	108"	325K	3
	120"	450K	1/4
JUMBO SEE-THROUGH	24"	95K	32
	30"	110K	1/8
	36"	155K	26
	42"	170K	5/32
	48"	195K	19
	60"	235K	14

KIVA BURNER	18"	35K	50
	24"	49K	45
	30"	64K	42
GLASS BURNER	18"	49K	45
	24"	64K	41
	30"	79K	36
	36"	83K	7/64
	42"	87K	34
	48"	145K	27
	60"	165K	23